



## AJ CYLINDRICAL FENDER

AJ Cylindrical fenders are commonly used fenders recommended for all types of application to ensure a safe and linear berthing for many different kinds of vessels. Their simple design makes them a cost effective, long lasting solution for many dock applications and tug boats. Adequate installation is simply achieved by using chains, bars, ropes or specially designed ladder brackets.

### AJ Cylindrical Fender Dimension and Reaction/Energy Performance

Reaction R: KN Energy E: KNm Type: Y Dxd	Design Deflection 50%				Weight Kg/m
	RO Grade		RH Grade		
	R:KN	E:KNm	R:KN	E:KNm	
Y150*75	44	1.5	73	2.3	17.2
Y200*100	60	2.6	95	4.2	30.6
Y250*125	75	4	120	6.5	48
Y300*150	89	6	143	9	69
Y350*175	104	8	167	13	94
Y400*200	119	10	191	17	123
Y500*250	148	16	239	26	191
Y600*300	179	24	286	37	276
Y700*350	208	31	334	50	375
Y800*400	237	41	383	66	490
Y900*450	268	52	430	84	620
Y1000*500	297	64	479	103	766
Y1100*550	331	77	528	129	727
Y1200*600	363	95	574	152	1103
Y1300*650	392	108	623	179	1294
Y1400*700	422	128	670	208	1500
Y1500*750	451	147	718	238	1720
Y1600*800	481	176	776	282	1960
Y1700*850	511	206	824	338	2210
Y1800*900	541	247	872	406	2480
Y1900*950	570	288	920	487	2765
Y2000*1000	653	321	1054	584	3063

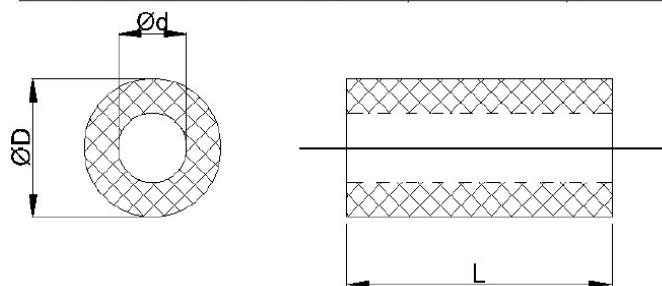

### AJ Cylindrical Fender Deflection Curve

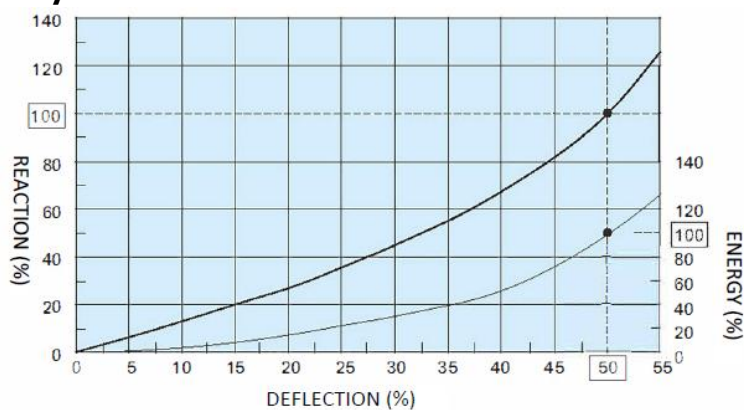



## Typical Installations

